

GYPSA ACCESS PANEL

www.gypsatrading.com

Welcome to the world of Access Panels with modern technology...

OUR SUCCESS STORY

Gypsa Access panel is designed specifically for installation in drywalls and ceilings. We take pride in offering the best access panel in the market.

Access panels are gypsum based built in accessories for ceiling. They are planted in various area of the suspended ceiling, shaftwalls or drywall parttions that requires access for constant adjustments, inspections and revisions. Ventilation ducts, electrical control outlets, pipe and valves can be given as an example to these areas.

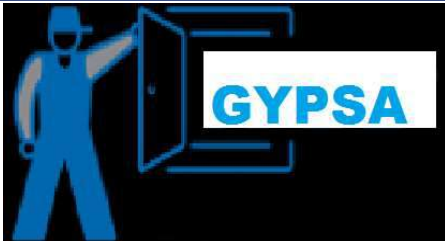

WE ARE COMMITED TO PROVIDE THE BEST LOCK SYSTEM FOR ACCESS PANEL IN OUR INDUSTRY; WE USE THE CONCEALED MACHNICAL TOUCH LATCH WITH THE SUSTAINABLE QUALITY.



ACCESS PANEL MANUFACTURING

Gypsa Smart Access Panel with Gypsum Board!

Are you looking for access panel or Push up doors with Gypsum Board for your Coming project? Our access panels Brings secure entrance points for crawlspace, plumbing or renovation jobs for your ceiling or drywall. They are engineered for a clean final finish and will last for a very long time. Access panels are useful in a wide range of commercial and residential locations. Another great benefit to these panels is they provide an aesthetically pleasing way to hide your cables, unsightly wires, and even water vales. It provides complete access to your ceiling and drywalls.

Gypsa Group offers different types of Push Up door/panels in our product range, including Normal access panels, Moisture Rated access Panels, non- fire rated Panels and more.

If you have any questions or concerns about our designs or sizes of access Panels, please contact our customer representative for more information.

Quality is not an act, it is a habit.

Access panel with different sizes are available we can manufacture your custom size upon technical evaluation and Minimum order quantity.

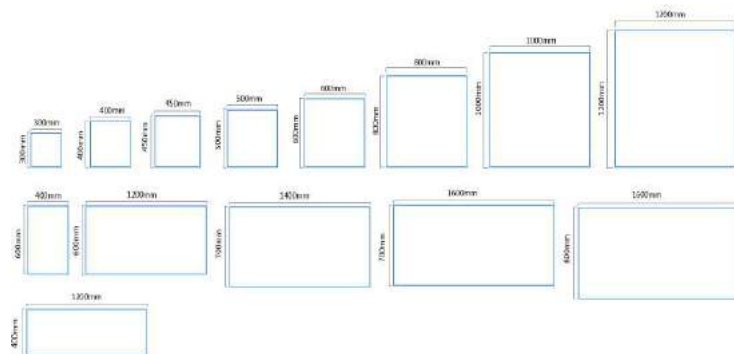

Get your project started: Order access panels factory-direct!

GYPSA ACCESS PANEL

www.gypsatrading.com

GYPSA ACCESS PANEL PUSH UP DOORS

Virtually Invisible Access Panels

Access Panels provide into drywall walls and ceilings. A number of innovative design features make them virtually invisible and flush in the finished wall and ceiling. The door panel receives the same finish as the surrounding surface and can be removed for full access. Suitable for both new construction and repairs.

Panels arrive ready for installation. The best finishes of access in ceiling and in drywall.

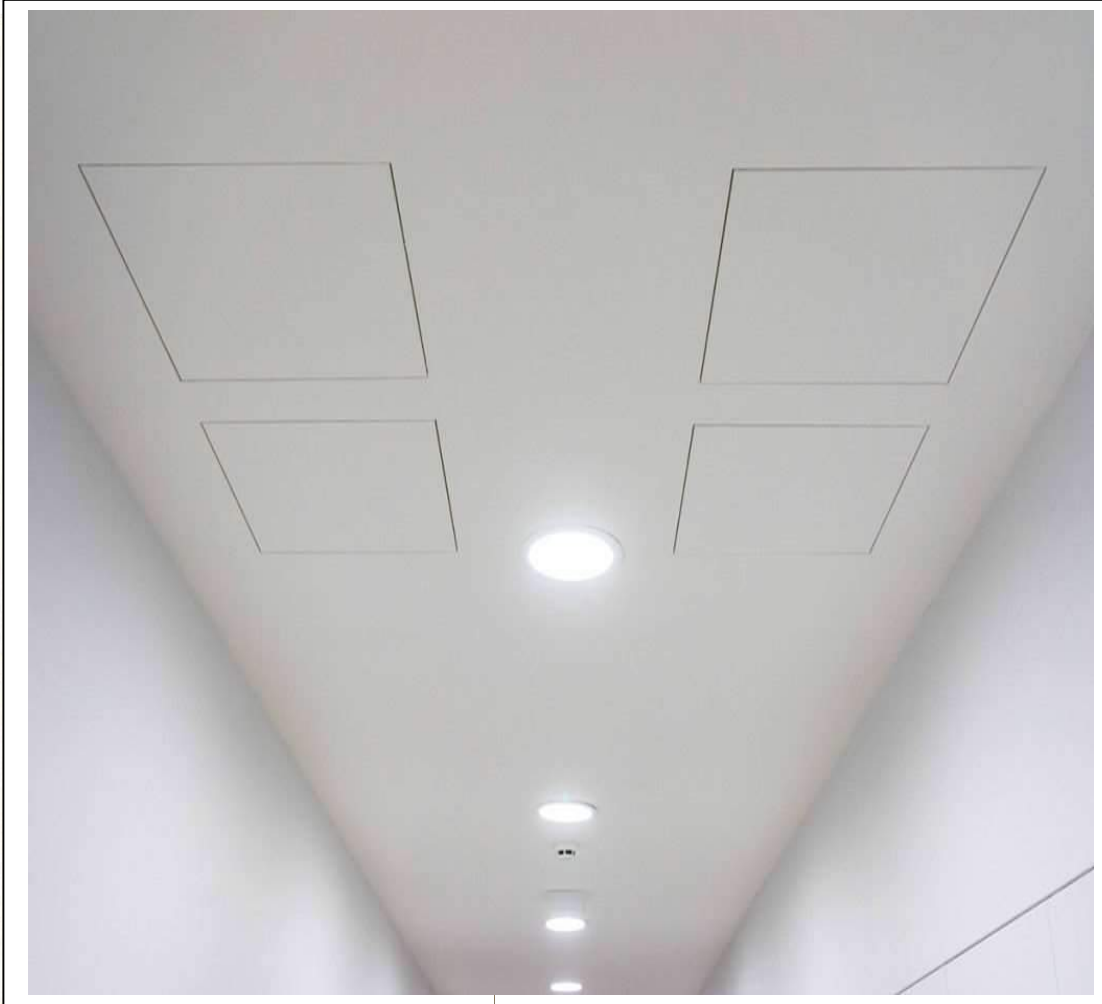

FEATURES:

1. Easy installation
2. Widely used
3. Stable quality

APPLICABLE SCOPE:

Widely used in government departments, airports, star hotel, hotels, office buildings, villas, shops and other places of household, easy transportation, easy construction, the product is not easy to damage, have fire prevention, environmental protection, etc.



WITH GYPSUM BOARD



WITHOUT GYPSUM BOARD



L
A
T
C
H

O
P
T
I
O
N
S



Touch Latch



Keyed Lock



CAM lock



GYPSA ACCESS PANEL

www.gypsatrading.com

GYPSA ACCESS PANEL SIZE CONSULTATION

Access Panel with Single Leaf Doors

Standard sizes from 200x200 mm to 1200x3000 mm

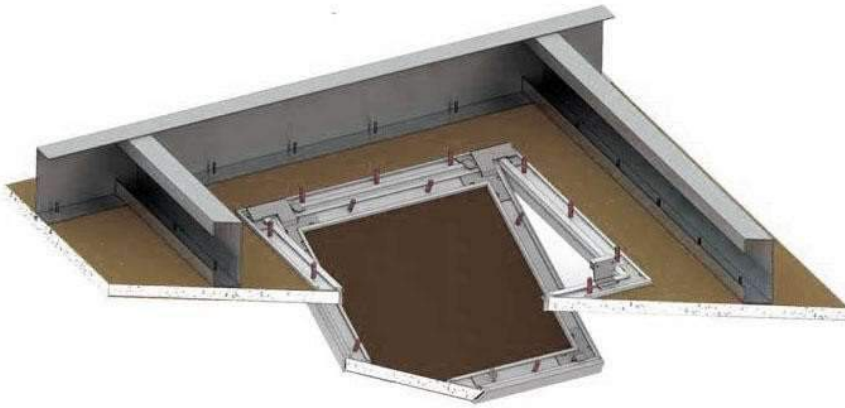

Custom Sizes are available



Single Door custom sizes

Example of Custom Size 200x217 mm, 1000x 219 mm

Larger access panels may need to be manufactured as two leaf doors or more.

Standard Sizes

200 x 200 MM
300 x 300 MM
400 x 400 MM
450 x 450 MM
500 x 500 MM
600 x 600 MM
600 x 1200 MM
800 x 800 MM
1000 x 1000 MM
1400 x 700 MM
1600 x 800 MM

Installation View





GYPSA ACCESS PANEL

www.gypsatrading.com

GYPSA ACCESS PANEL MULTI_LEAF DOORS

Access Panel with Multi-leaf Doors

Multi Leaf Custom Doors: Multi leaf access panels shall be used to achieve a Large Clear opening. There are no cross bars required.

1. Butter Fly Style

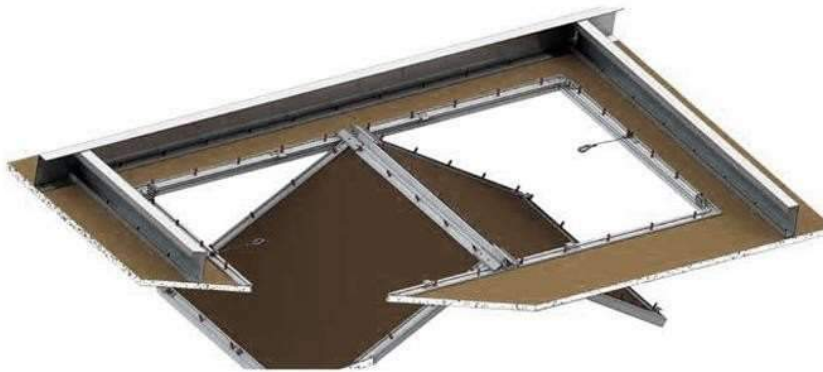

2. Classic Door Style

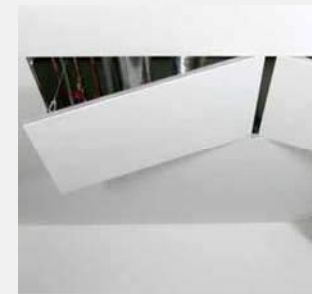

Multi-leaf Door Custom Sizes:

1. Multi-leaf doors can be customized to suit most large openings
2. Multiple, hinge less, fully removable sections
3. No Centre Bar
4. Double leaf doors typically hinge in the center
5. Door leaves can be removed for full access

Gypsa Access Panels in Custom size doors *can* be manufactured as Two-leaf doors in Butterfly and in classic door styles. There are no cross Bars at the centre on either design, just a continuous clear opening.

Note: Clear opening, no cross bar. Size restrictions apply to Class Door style.



GYPSA ACCESS PANEL

www.gypsatrading.com

GYPSA ACCESS PANEL RANGE

Virtually Invisible Panel designed for Ceiling and Drywall

The **Gypsa Access Panel** is a gypsum board access panel with concealed hardware that blends seamlessly into your wall or ceiling. Once installed and finished to match the surrounding area, a clean 1/16" reveal is all that remains visible. All elegant and functional surface treatments can be applied. The **Gypsa Access Panel** is available in a wide range of custom sizes for your different areas conditions.

Our range of Access Panels:

1. **Moisture Rated Access Panel:** *Moisture rated access Panel Are made up With Aluminum Frame and Moisture Rated Gypsum plaster Board.*
2. **Non Fire Rated Access Panel:** *Non fire rated access Panel are made up with Aluminum Frame and Fire Rated Gypsum plaster Board*
3. **Regular Gypsum Board Access Panel:** *Moisture rated access Panel are Made up with Aluminum Frame and Normal Gypsum plaster Board*



Our designs are Decorous and visually appealing. The panels are easily finished to match surrounding areas - whether with tile, wallpaper, paint or veneer. The Royal Quality of **Access panel** has Become the industry standard for Major Construction Projects.

FOR IN USE

1. All assemblies clad in gypsum board, 9mm to 25 mm
2. Wall or ceiling installation
3. New construction or repairs
4. Rough openings in GWB independent of joists/studs
5. Custom size
6. Its applicable to Fire and Non fire Rated Areas

BENEFITS

1. Virtually invisible access opening
2. (1-2 mm) visible gap
3. Clean, continuous surfaces without visible hardware
4. Variety of finishing options
5. Superior acoustics with gasket and mass of GWB in door
6. Maximum clearance with removable door leaf
7. Custom sizes, custom inlays, and custom hardware



GYPSA ACCESS PANEL CUSTOM SOLUTIONS

Design Consultation

Customized inlay Design Option

1. Additional GWB Layers
2. Tile Backer Board
3. Acoustical Inlay Options
4. Cement Board
5. Imperial Veneer Plasterboard
6. Fiberboard (MDF)
7. Preparation Wood Inlay/Veneer
8. White Pvc laminate

Standard Features

1. Concealed mechanical touch latch
2. Moisture and mold resistant GWB inlay
3. Strong concealed aluminum frame and hardware
4. Removable door leaf with safety cables
5. EPDM rubber perimeter gasket (air and smoke tight)

Latch Options

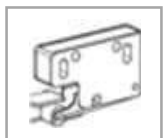

Touch Latch



Keyed Lock

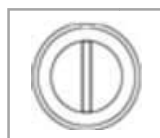

CAM latch



TORX latch

Note : Access door sizes are based on inside dimensions, door size (A)



GYPSA ACCESS PANEL

www.gypsatrading.com

GYPSA Circular access panel – Push to Open



Gypsa Circular gypsum (Round) board access panel based on the design principles; the panels are easily finished to match gypsum ceiling or wall. The quality of our circular ceiling access panel has become the industry standard for high-end construction projects.

Standard Features:

Frame: Aluminum 2.0 mm thick

Lock: Concealed hardware (frame, latch & hinge)

Finish: Powder coated & are available in any RAL color

Frame: Fits both 12.5 mm and 15 mm gypsum board

Door: MR, FR, Regular, Antibacterial, FM and sound bloc gypsum wallboard inlay

Size: Standard (30 dia, 45 dia, 60 dia & Custom sizes are available upon request

Range of use: Ideal for Ceilings in Residential, Commercial & Industrial Buildings

Benefits:

Easy installation with common trowel tools and included fasteners

Gypsum surfaces suited to elegant and functional treatments

Consistent continuous surfaces for virtually invisible access (only a 1.5 mm void remains visible)

Rough openings in GWB without abutting structures

Fully removable door panel with safety cables



GYPSA ACCESS PANEL

www.gypsatrading.com

AL HOTY - STANGER LABORATORIES
Independent Testing Laboratories
and Materials Consultants



مختبرات الحوطي ستانجر
مختبرات فحص مستقلة -
مستشارو المواد

TEST REPORT

GYPSA TRADING FZC.

TENSILE TESTING OF METALLIC MATERIALS

Report date: 12.12.17

Report no.	: D17 - 285182- 1	Sample location	: Not Given
Project no.	: Not Given	Sampled by	: Client Rep.
Project name	: Quality Assurance.	Sampling date/time	: 28.11.17 / Not Given
Consultant	: Not Given	Sample delivered by	: Client Rep.
Sample description as identified by the client	: Gypsa Gypsum Access Panel.	Date/time sample received	: 28.11.17 / 1615 Hrs.
Nominal size	: 1.8 mm thick	Date tested	: 08.12.17
Grade	: AA 6063	Tested by, name/ location	: PP,ABS / DXB
Local supplier/.Source	: Not Given	Test method	: BS EN 10002-1:2001

Results:

SPECIMEN NO.	D17 - 285182- 1	
Tensile Load	kN	2.8

Remarks: None

Test method variation: None

This report relates only to the sample tested and shall only be reproduced in full and with the written approval of AHS Laboratories.

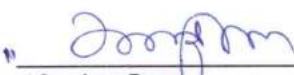
Alquinn Lapuz
DHOD- Civil Department, Dubai.





GYPSA ACCESS PANEL

www.gypsatrading.com

ACCESS PANEL SINGLE DOOR WITH LATCH

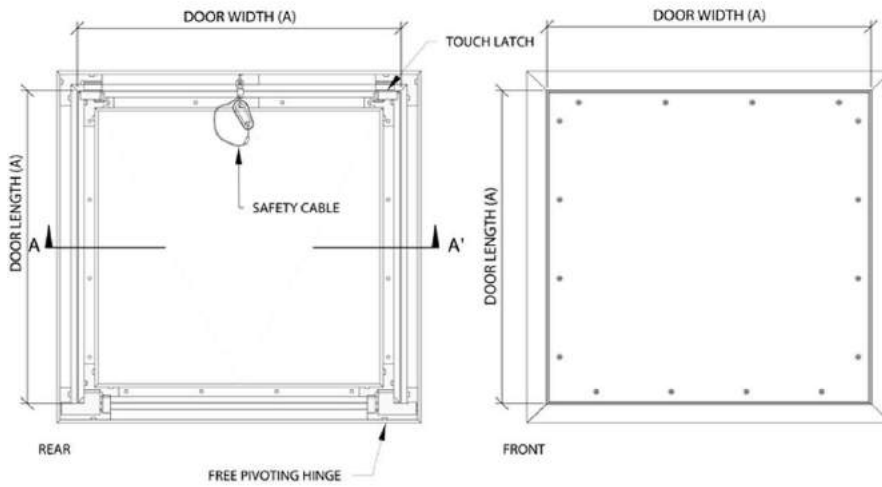

FOR USE IN:

- ASSEMBLIES CLAD IN GYPSUM WALLBOARD 1/2" (13 mm) OR 5/8" (16 mm)
- NEW CONSTRUCTION OR REPAIRS
- ROUGH OPENINGS IN GWB WITHOUT ABUTTING STRUCTURES

FRAME:

- RECESSED CONCEALED ALUMINUM EXTRUSIONS
- FRAME ACTS AS FINISHING EDGE
- 1/16" (2 mm) GAP BETWEEN FRAME AND DOOR

STANDARD FEATURES:

- STRONG CONCEALED ALUMINUM FRAME AND HARDWARE
- CONCEALED MECHANICAL TOUCH-LATCH
- LIFT-OUT DOORS WITH SAFETY CABLES
- MOISTURE RESISTANT GWB INLAY
- PERIMETER GASKET (AIR & SMOKE TIGHT)

HINGE:

- FREE PIVOTING HINGE
- DOOR CAN BE REMOVED FOR MAXIMUM CLEARANCE

LATCH:

- CONCEALED TOUCH LATCH (STANDARD)
- CAM LATCH (OPTIONAL)
- TAMPER RESISTANT CAM LATCH (OPTIONAL)
- KEYED LOCK (OPTIONAL)

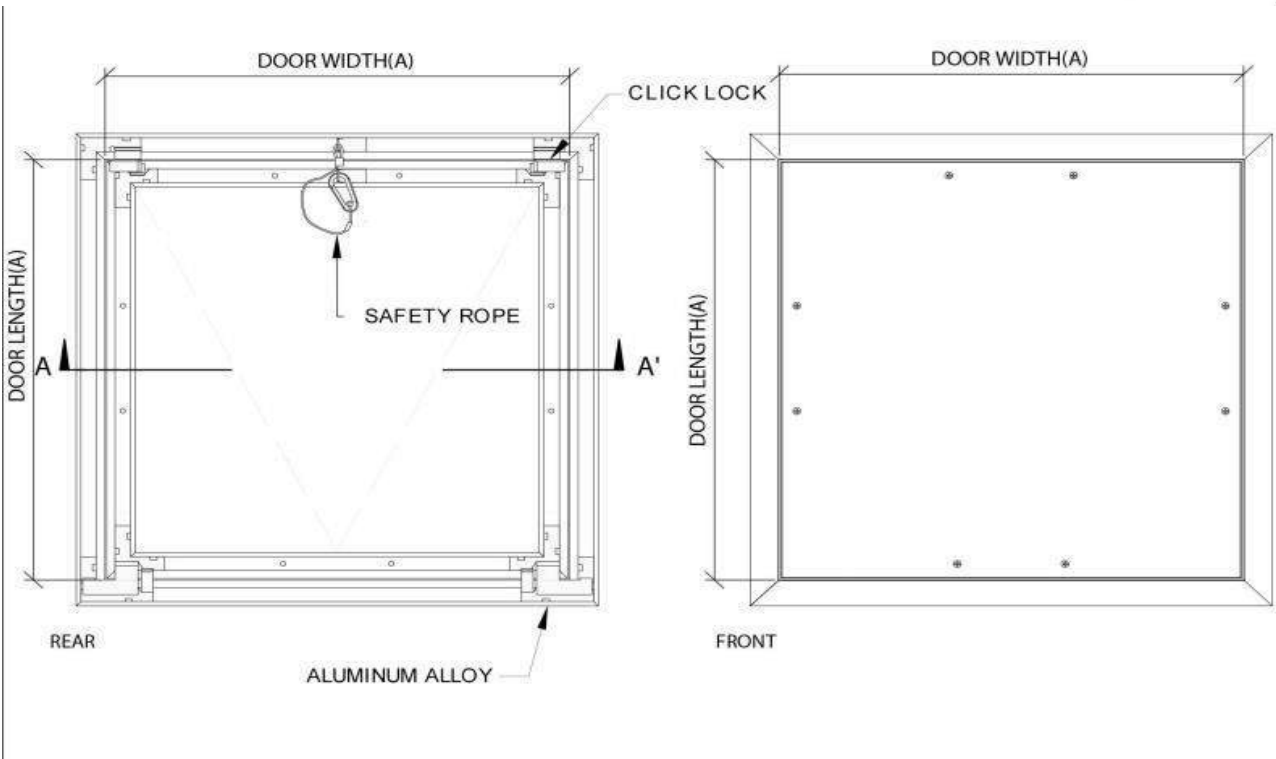
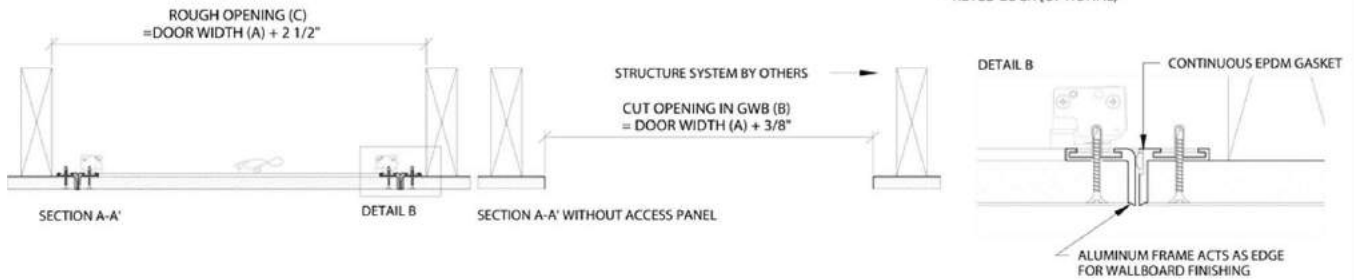



GYPSA ACCESS PANEL

www.gypsatrading.com

ACCESS PANEL TWO LEAF DOOR WITH LATCH

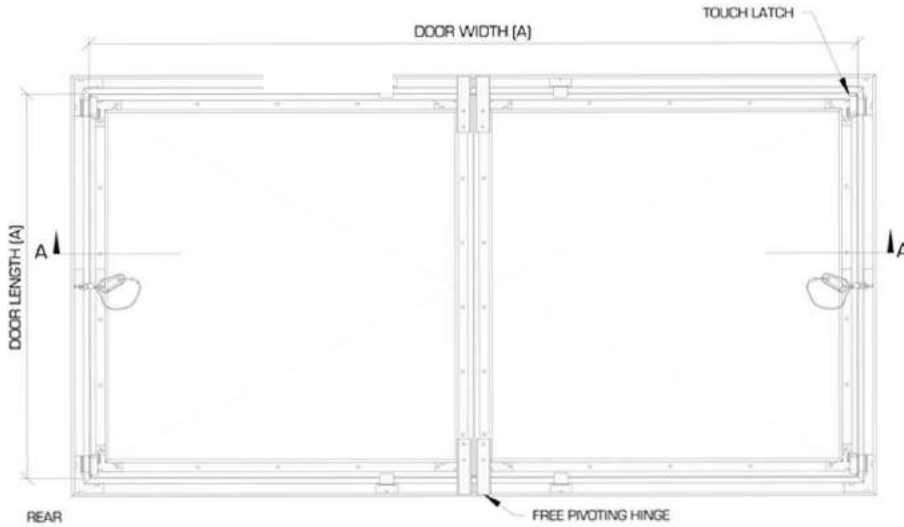

FOR USE IN:

- ASSEMBLES CLAD IN GYPSUM WALLBOARD 1/2" (13 mm) OR 5/8" (16 mm)
- NEW CONSTRUCTION OR REPAIRS
- ROUGH OPENINGS IN GWB WITHOUT ABUTTING STRUCTURES

FRAME:

- RECESSED ALUMINUM EXTRUSIONS
- FRAME ACTS AS FINISHING EDGE
- 1/16" (2 mm) GAP BETWEEN FRAME AND DOOR

STANDARD FEATURES:

- STRONG CONCEALED ALUMINUM FRAME AND HARDWARE
- CONCEALED MECHANICAL TOUCH-LATCH
- LIFT-OUT DOORS WITH SAFETY CABLES
- MOISTURE RESISTANT GWB INLAY
- PERIMETER GASKET (AIR & SMOKE TIGHT)

HINGE:

- FREE PIVOTING HINGE
- DOOR CAN BE REMOVED FOR MAXIMUM CLEARANCE

LATCH:

- CONCEALED TOUCH LATCH (STANDARD)
- CAM LATCH (OPTIONAL)
- TAMPER RESISTANT CAM LATCH (OPTIONAL)
- KEYED LOCK (OPTIONAL)

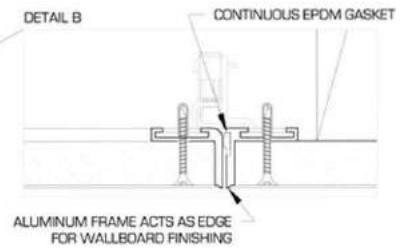

ACCESS PANEL THREE LEAF DOOR WITH LATCH LOCK

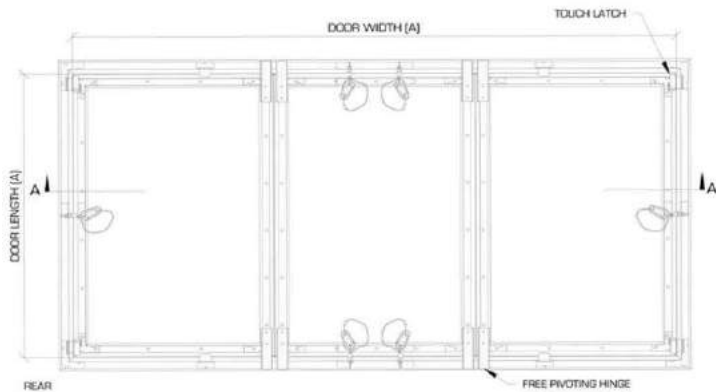

FOR USE IN:

- ASSEMBLES CLAD IN GYPSUM WALLBOARD 1/2" (13 mm) OR 5/8" (16 mm)
- NEW CONSTRUCTION OR REPAIRS
- ROUGH OPENINGS IN GWB WITHOUT ABUTTING STRUCTURES

FRAME:

- RECESSED ALUMINUM EXTRUSIONS
- FRAME ACTS AS FINISHING EDGE
- 1/16" (2 mm) GAP BETWEEN FRAME AND DOOR

STANDARD FEATURES:

- STRONG CONCEALED ALUMINUM FRAME AND HARDWARE
- CONCEALED MECHANICAL TOUCH-LATCH
- LIFT-OUT DOORS WITH SAFETY CABLES
- MOISTURE RESISTANT GWB INLAY
- PERIMETER GASKET (AIR & SMOKE TIGHT)

HINGE:

- FREE PIVOTING HINGE
- DOOR CAN BE REMOVED FOR MAXIMUM CLEARANCE

LATCH:

- CONCEALED TOUCH LATCH (STANDARD)
- CAM LATCH (OPTIONAL)
- TAMPER RESISTANT CAM LATCH (OPTIONAL)
- KEYED LOCK (OPTIONAL)

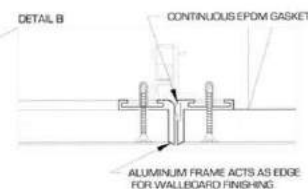



GYPSA ACCESS PANEL

www.gypsatrading.com

GYPSA ACCESS PANEL Installation Method

Installation Method

The framing should be placed correctly around the opening in the drywall for the access panel. Drywall is linked to the studs as usual but overlaps to create a lip to bring the access panel outer frame. The cut Opening required for the access panel is cut and the frame angled through the opening and attached according to the information on in the Image.

Ex: For a Model Number 12" x 12" clear opening, the minimum spacing of the framing is 14 1/2" with 1 1/4" on either side of the opening. The maximum spacing is 20" with 4" maximum on either side of the opening. The distance to the studs does not have to be the same as long as the framing is within the maximum and minimum dimensions.

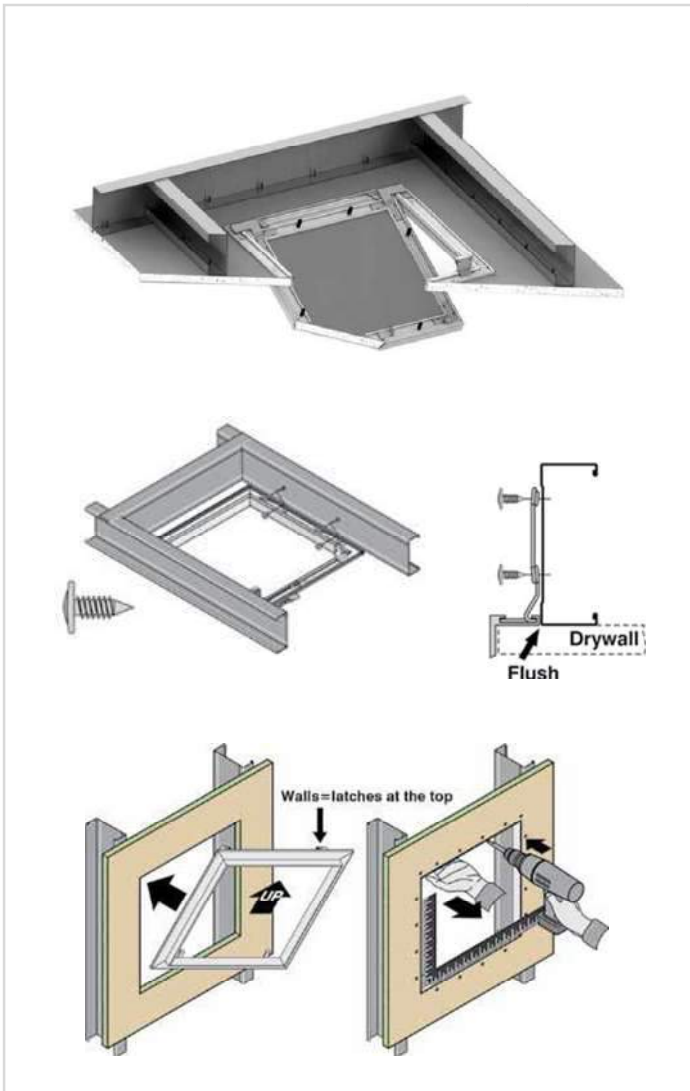

Step 1: Locate the Fixture

Whatever needs accessing, make sure you know exactly where it is. Ideally, before you hung the drywall you took accurate measurements of the fixture's location, whether it is a valve, wiring hub or removable pipe cap. That way, when cutting the drywall, you will know precisely where to install the access panel. Otherwise, the process will be somewhat blind. If you cut into the drywall but make a mistake, you will have to patch it. Basically, it is best if you know the precise location of what you need to access.

Step 2: Cut a Small Hole in the Drywall

Check your measurements by cutting a small hole into the drywall right at the point the fixture should be. Use the drywall saw. This starter hole will let you know where you should install the access panel.

Step 3: Trace the Access Panel Frame

Hold the access panel frame in position against the wall. Make sure it is even and trace along the inside edge. The small hole you first cut should be contained within the traced box.

Step 4: Cut Out just Around the Traced Area

Once again, take the drywall saw and cut just outside of the traced area. The lip of the access panel frame requires that the hole be a bit bigger on all four sides to allow it to fit in. The extra size should be no more than 1/4 inch on all sides.

Step 5: Fit the Frame

Test out the frame to make sure it fits snugly in the cut-out hole. If it is too tight a fit, take the drywall saw and saw along the edges of the cut to make the hole bigger. Be careful not to make the hole too big, though.

Step 6: screw the Frame to Drywall

Screw the Drywall screw to the frame on the drywall edge where access panel is located. With the screw in place, put the frame into the opening and press it against the drywall. Be sure that all sides of the frame contact the drywall equally.

Step 7: Finish the Frame

By applying the gypsum plaster on the edge of the opening door Frame through which the cut area of the plaster board can make it more fished and the gap of the frame will be not visible from 1.5 Mtr, after finish the frame



GYPSA ACCESS PANEL

www.gypsatrading.com

GYPSA ACCESS PANEL INSTALLATION INSTRUCTIONS

Tools Required



Measuring and cutting the rough opening:

- 1 Determine the location for the Access Panel and note the position of studs or joists.
- 2 Measure the **inside** dimensions of the frame (not the door). Add $\frac{3}{8}$ " (9.5mm) to each dimension.

Frame (shown with hatch open)

Door Size is opening in frame dimensions.

A and B are the dimensions of opening in the frame

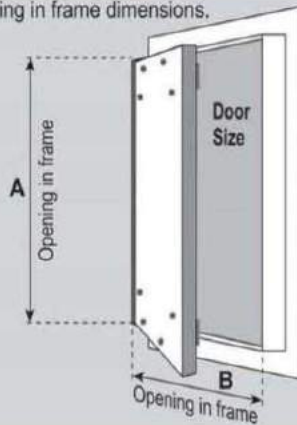

Standard ceiling and walls -stud or joists at 16" (406 mm) center

The illustration below shows the maximum size of the frame that fits between joists or studs on standard center.

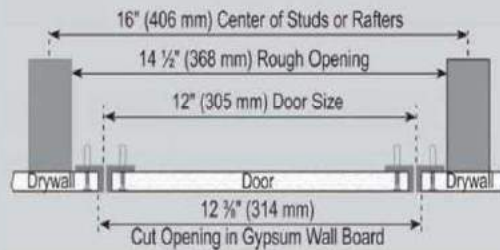

Opening in gypsum wall board

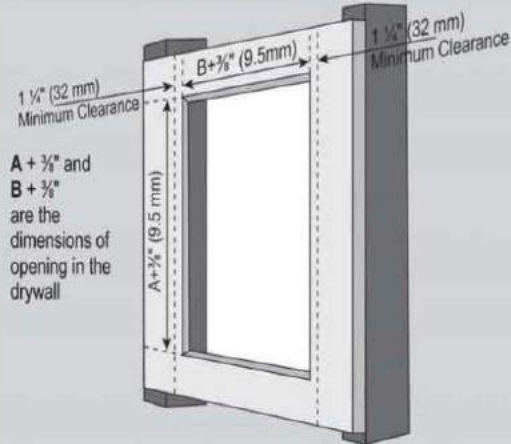

A + $\frac{3}{8}$ " and B + $\frac{3}{8}$ " are the dimensions of opening in the drywall

Minimum clearance to studs from cut opening

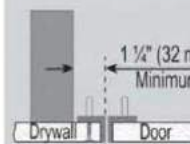

Maximum clearance to studs from cut opening

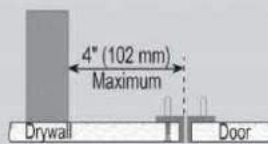

- 3 Mark a pair of base lines 90° to each other on the ceiling or wall where the hole will be. These must be a **minimum** of $1\frac{1}{4}$ " (32 mm) and a **maximum** of 4" (102 mm) away from a stud or joist. Mark the opposite sides using the dimensions in Step 2. Accurate marking is very important and make sure that the lines are square.
- 4 Cut the opening with a knife, saw or drywall cutter. Make sure the edges are clean.



GYPSA ACCESS PANEL

www.gypsatrading.com

GYPSA ACCESS PANEL SPECIFICATIONS

Model Name:	ACCESS PANEL for Drywall and Ceiling
Description:	GYPSA ACCESS PANEL are virtually invisible access panel installs flush with wall and ceiling finishes. Finished panels leave not more than a 1/16" shadow/gap on finished Surfaces. Hardware-free finish, opens with concealed touch latches. May be removed for full access, complete with safety catches. Suitable for new Construction and repairs. Panels arrive ready for installation with factory Installed gypsum board inlay. Door panel receives the same finish as the Surrounding surface. Aluminum extrusion with gypsum board installed, No corrosive hardware, safety devices, installation kit, and bracing where needed. Standard: touch latch. Options: keyed latch, special board, acoustic backing. Panel drywall inlay shall equal the same specifications as wall and Ceilings.
Finishing:	No bead required. Feather mud so that after the 3rd layer no irregularities Shall be visible to the unaided eye at a distance of 1.5 m.
Dimensions:	Standard sizes: 200x200 mm to 1200x3000 mm We can manufacture custom sizes upon technical evaluation and Minimum Order quantity.
Sizing:	For a proper fit, the rough opening has to be 2 1/2" wider and longer than the door size, to a maximum of 8". Cut opening in the gypsum wallboard will be the door size + 3/8".
Properties:	<ol style="list-style-type: none">1. Corners of exterior and interior frames reinforced through non-corrosive galvanized steel angles.2. Flap is secured by the galvanized angle on the high side3. Open and close by applying pressure on the latch side.
Removable Flap:	<ol style="list-style-type: none">1. Continuous white seal (about 1 mm thick) between frame and flap.2. The flap is to be finished co-extensive with surrounding surface.
Additional Feature:	Also available in specialized designs: Brush, Cylinder Lock, Square Tumbler Lock
Material:	Exterior and interior frames made from stable aluminum profile
Material crew:	Phosphate, rust-prevented, pike protected with cap, distance max 20 cm from screw to screw.
Aluminum Profile:	T6- 6063, Connecting Parts: Galvanized steel, 1.5 mm



GYPSA ACCESS PANEL

www.gypsatrading.com

GYPSA ACCESS PANEL LEED STATEMENT

LEED for Gypsa Access Panels with Gypsum Board Inlay

Gypsa Group is comprehensive Enterprise manufacturing Ceiling and Decoration Building Material since a decade. We are a professional Manufacture of **Gypsa Access Panel** and Access doors Head quarter In Sharjah, UAE also established in India, Dubai and Qatar. We are supplying our access Panel about 23 Countries across the Globe.

At **Gypsa Access Panel Solutions**, we are proud to be the most customer-responsive Access panel company in the industry. We accomplish this by being both the manufacturer and distributor of access panels and access doors which allows us to provide short production lead times, custom sizes, and superior delivery logistic. We are ready to assist in your LEED certification documentation.

Manufacturing Location Industrial -6, Sharjah, UAE

Material Quality Our Products are Tested and Certified by local renowned agencies.

Recycling Content

Material content By Weight	Total %	Post-industrial Recycled Content	Post-consumer Recycled Content	Recycled %
Aluminum Extrusion	23%	25%		5.8%
Steel Hardware	7%	50%		3.5%
Gypsum board	70%		21%	14.7%
Total Weight	100%			24%

* Vendors report recycling content up to 90%, but this figure can vary

Web: www.gypsatrading.com | Email: info@gypsatrading.com | Fax: 06 5542030 | Mob: 052 9399506/ 056 7878010



GYPSA ACCESS PANEL

www.gypsatrading.com



About Us

GYPSA specialize in manufacturing large CUSTOM SIZE access panels with varying hinge, lock and finish options to meet architectural specifications. The GYPSA Access panels adopts suitable to any environment, whether it's for the drywall or gypsum ceiling or any other surface

Stainless Steel Access Panels

GYPSA SS-1 series, Stainless Steel Access Panels are manufactured in UAE and have been designed for use where an aesthetically pleasing solution is required for access into walls, ceilings and service shafts. They are secured with a square cam lock as standard, however a key lock option is also available (please note locks are not stainless steel).

They can also be purchased in non-lockable form which feature

- Concealed touch latches.
- UAE made and superior quality.
- Single and double door custom sizes.
- Key lock options available.
- Stainless Steel Access Panels



Tileable Access Panels

GYPSA TA-1 series, Tile able Access Panels are manufactured in UAE and have been designed for use where an access panel is required to be discretely installed into a tiled wall or ceiling. These panels are constructed using a fiber cement door and stainless steel frame, allowing for use in harsh environments. An economical pre-primed steel frame is also available.

- Clean architectural finish.
- Stainless steel frame as standard.
- Key lock option available.
- Tileable Access Panels



Custom Access Panels

GYPSA CT-1 series, specialize in manufacturing large custom size access panels and our extensive experience and knowledge ensures we can provide a solution for all your access needs.

- UAE made and superior quality.
- Single and double door metal access panels.
- Varying hinge and lock options available.
- Gypsa specialize in custom sizes.
- Specialty Access Panels (Custom



GYPSA ACCESS PANEL

www.gypsatrading.com

Gypsa Smart Access Panels

Gypsa SA-1 series, Access panels are gypsum based built in accessories for ceiling. They are planted in various area of the suspended ceiling, shaft walls or drywall partitions that requires access for constant adjustments, inspections and revisions. Ventilation ducts, electrical control outlets, pipe and valves can be given as an example to these areas.

- UAE made and superior quality.
- Architectural access panels with concealed hardware and gypsum board inlay
- Gypsum surfaces suited to elegant and functional treatments
- Consistent, continuous surfaces with factory-installed gypsum board inlay
- Easy installation with common trowel tools
- Concealed hardware (frame, latch, & hinge)
- Removable door panels with safety cables
- Fully removable door
- Great for Mechanical Access, HVAC Access, Fan Coil Access, and Electrical Access



Gypsa Hing Access Panels

Gypsa HA1 series, Access panels are permanent devices that provide entry in to an enclosed area. Access panels can be used in any internal ceiling/ partition construction where easy access is required

- UAE made and superior quality.
- To be painted or decorated
- No visible metal edges- concealed hinges
- Architectural access panels with concealed hardware and gypsum board inlay

Can be produced in Single, Double, Triple and Tetra doors (From 1.2 wide to 3.0 mtr long)

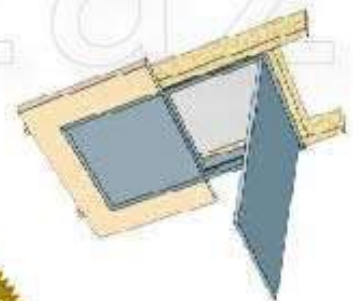

Gypsa Circular Access Panels

GYPSA CA-1 series, Attractive round access panels provide permanent access to service areas behind drywall ceilings/walls (ductwork air damper controls, electrical junction boxes, plumbing, telephone systems, sprinkler systems, etc.)

Easy installation with common trowel tools and included fasteners

- UAE made and superior quality
- Gypsum surfaces suited to elegant and functional treatments
- Consistent continuous surfaces for virtually invisible access (only a 1.5 mm void remains visible)
- Rough openings in GWB without abutting structures
- Fully removable door panel with safety cables



GYPSA ACCESS PANEL

www.gypsatrading.com



Gypsa GI wall Access Panels

For many years Gypsa GW-01 series has earned a reputation for providing the construction industry with affordable quality products. In addition to offering a wide variety of standard styles and sizes, we have the manufacturing capability and engineering know-how to supply custom made products to meet any need of the industry.



- MATERIAL** ▶ Stainless steel, GI., Aluminium
- TYPE** ▶ Flush, Recessed (F/R, Non F/R)
- LATCH** ▶ Screw driver, Uni. Key operated
- HINGE** ▶ Continuous, Concealed
- OPENING** ▶ Spring assisted

Gypsa Roof Hatches

Gypsa roof hatches are standard in aluminum and galvanized steel. The hatch cover opens easily and remains open safely during use. The clear hatch opening is unobstructed.

- MATERIAL** ▶ ss, Aluminium, GI
- LATCH** ▶ Self Locking, Pad Lock
- OPENING** ▶ Spring Assisted with hold open arm
- COVER** ▶ Single/Multi leaf- Insulated / Non-insulated
- FRAME** ▶ Insulated, with fixing holes
- FINISH** ▶ Brush/Mill, painted, power coated



Floor Access Covers Manholes & Water Tank

Manhole covers can be integrated in the overall concept as a final component in a supply and disposal unit. Stainless steel, material grade 304 suitable for use e.g. in the meat and beverage industry and in the chemical and food industry. Galvanized steel manhole covers are used in public housing construction and for production and storage areas. Aluminium manhole covers for use in more critical environments e.g. hotels and hospitals complete the product range.

- MATERIAL** ▶ Stainless steel, GI., Aluminium
- TYPE** ▶ Solid Top, Recessed, Drop In
- LATCH** ▶ Slam Lock, Pad Lock
- HINGE** ▶ SS Butt Hinge with, Spring
- OPENING** ▶ Hold Open Arm, Spring
- FINISH** ▶ Mill, Powder / Epoxy Coated

